



## Product details

**09 14 000 6257**

**Female contact**

Contact type    with shut off  
Diameter        3,0 mm  
Application     browsing..  
Series            Han® Pneumatic-module, 3-poles; 1.6 / 3 / 4mm  
RoHS compliant Yes

1 2 3 4 5 6

A

B

C

D

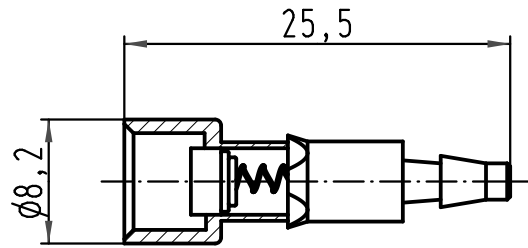

Kontakt für Schlauchinnendurchmesser 3,0 mm  
*tube fitting insert for tubing size ID 3,0 mm*

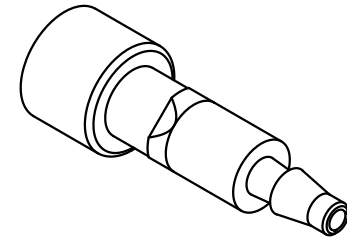

|   |          |      |                                |          |      |  |  |  |            |
|---|----------|------|--------------------------------|----------|------|--|--|--|------------|
| All Dimensions in mm<br>Original Size DIN A 4 |          |      | Techn. Character.              |          |      | Nicht tolerierte Maße/Free size tolerances |  |  |            |
|   |          |      |                                | Dat.     | Name | Maßstab/Scale<br><br>2:1                   | Han-Modular<br>Pneumatikbuchsenkontakt m. Absperrung<br><i>pneumatic female tube fitting<br/>         with shutoff</i> |  |            |
|   |          |      | Detail.                        | 20.10.98 | SPER |  |  |  |            |
|   |          |      | Insp.                          |          | SDT  |  |  |  |            |
|   |          |      | Stand.                         |          |      |  |  |  |            |
| 413153  | 27.08.07 | Bor  | HARTING Electric GmbH & Co. KG |          |      |  | <b>TB 09 14 000 6257</b>   |  | Blatt/page |
| 27321   | 07.03.00 | Gä   | D-32339 Espelkamp              |          |      |  |  |  |            |
| Mod.  | Dat.     | Name |                                |          |      |  | Sub. TB 09 14 000 6... v. 23.06.94   |  |            |